

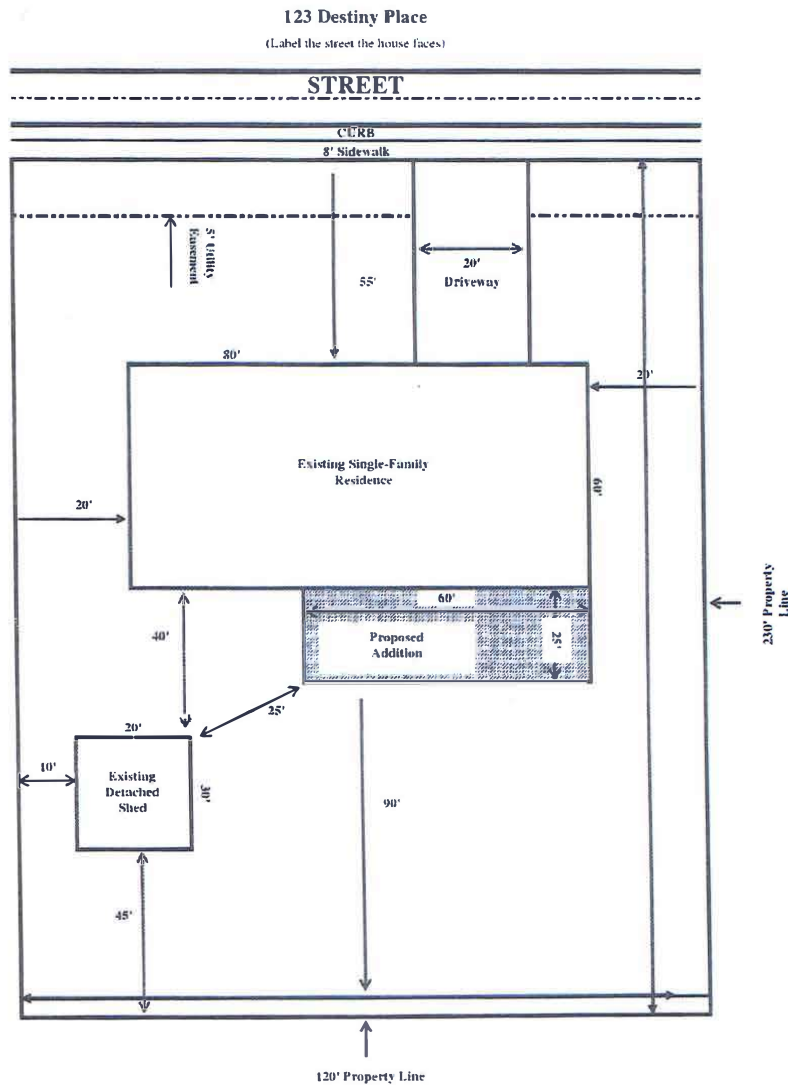

Terrebonne Parish Consolidated Government  
Department of Planning & Zoning Permits Division  
8026 Main Street, Suite 100 (985) 873-6567

**RESIDENTIAL PERMIT APPLICATION REQUIREMENTS**

**Basic Site Plan Example**



**The site plan must show:**

- ✓ The 911 address of the property and labeled intersections, if any.
- ✓ A depiction of the entire lot with dimensions for boundaries, setbacks, easements, rights-of-way, and servitudes. If you are unsure if your property includes setbacks, rights-of-way, or easements, consult the plat associated with your property. A copy of the plat can be obtained from the Terrebonne Parish Clerk of Court's Conveyance Records for a nominal fee.
- ✓ All existing and proposed features such as buildings, pools, driveways, and paved areas.

**Call 985-873-6568 to schedule an inspection.**